

Photoelectric Sensors Series OR12

Description **OR12SE-DOOS-01.0-SVC**

Article number **6551055003**

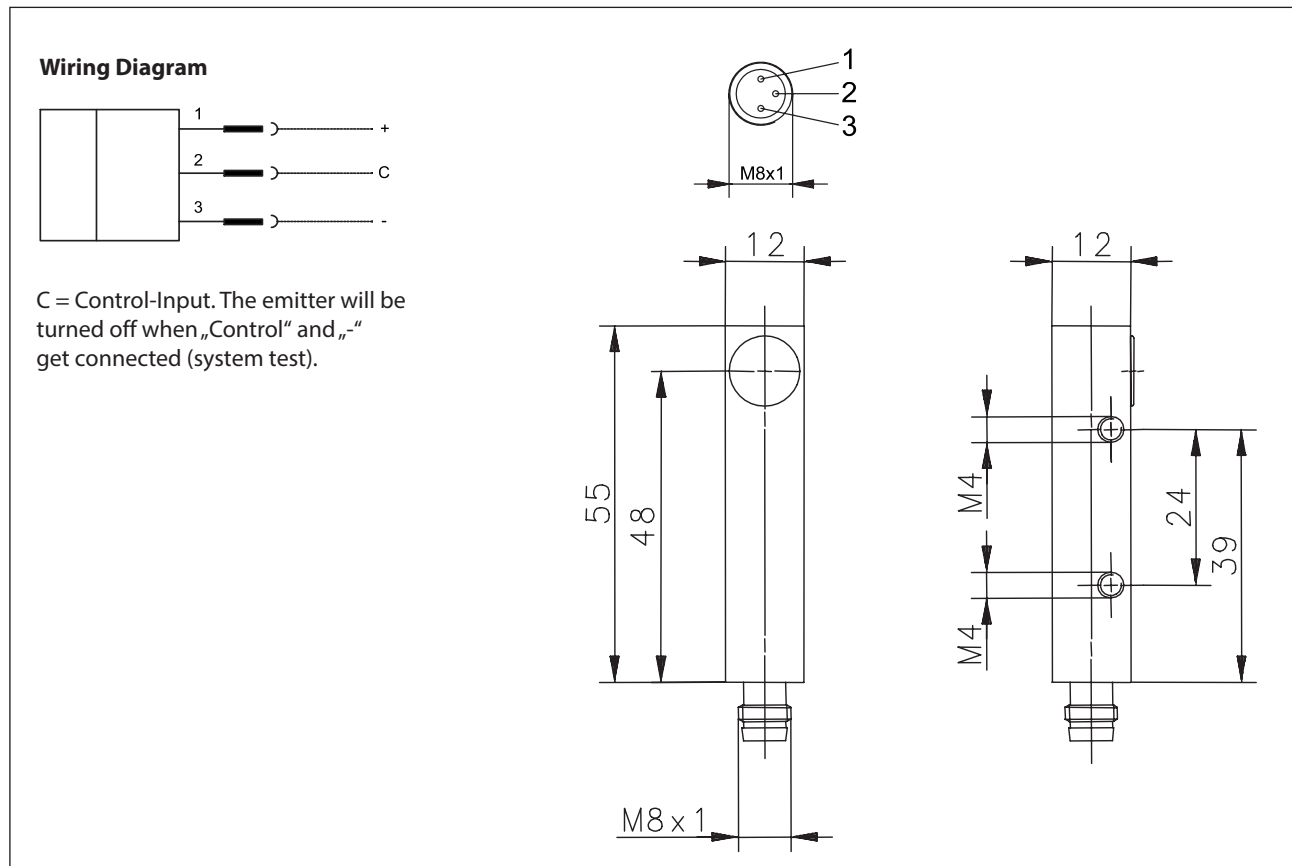

Identifying characteristics in accordance with EN 60947-5-2

Electrical data		
Sensing range	S_d	1 m
Rated operational voltage	U_e	12-24 V DC
Operational voltage range	U_B	10-36 V DC
Rated insulation voltage	U_i	75 V DC
Rated impulse withstand voltage	U_{imp}	500 V
Rated operational current	I_e	50 mA
No-load supply current	I_o	≤ 30 mA
False polarity protection		yes
Time delay before availability	t_v	< 15 ms

Mechanical Data	
Enclosure	brass, nickel plated
Beam-output	PA 12
Ambient air temperature	-5 °C ... +70 °C
Type of protection	IP65 (only in fully snapped-in position with it's plugs)
Pollution degree	3 (Pollution of the optic can cause impairments of the operating distances.)
Indication	LED green
Termination type	Plug-in connection

EU Conformity
acc. to directive 2014/30/EU (EMC-Directive)